

Ø15 ECCENTRICO CLOCK

Assemblaggio universale

Con tirante ad espansione per una velocissima installazione. Disponibile con interasse 24 o 34 mm. e nelle versioni Ø5, Ø8 e Ø10 mm. Può essere inserito o rimosso semplicemente con l'ausilio delle mani.

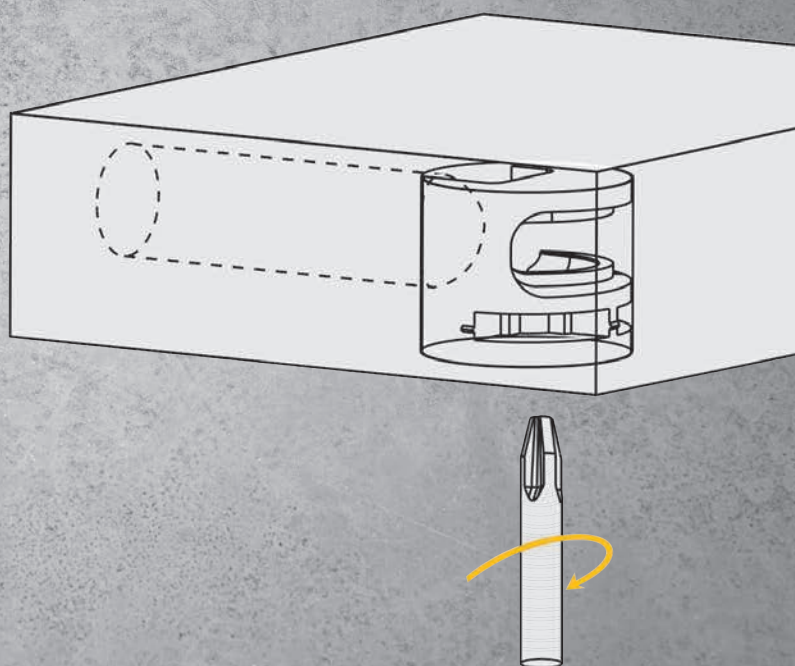
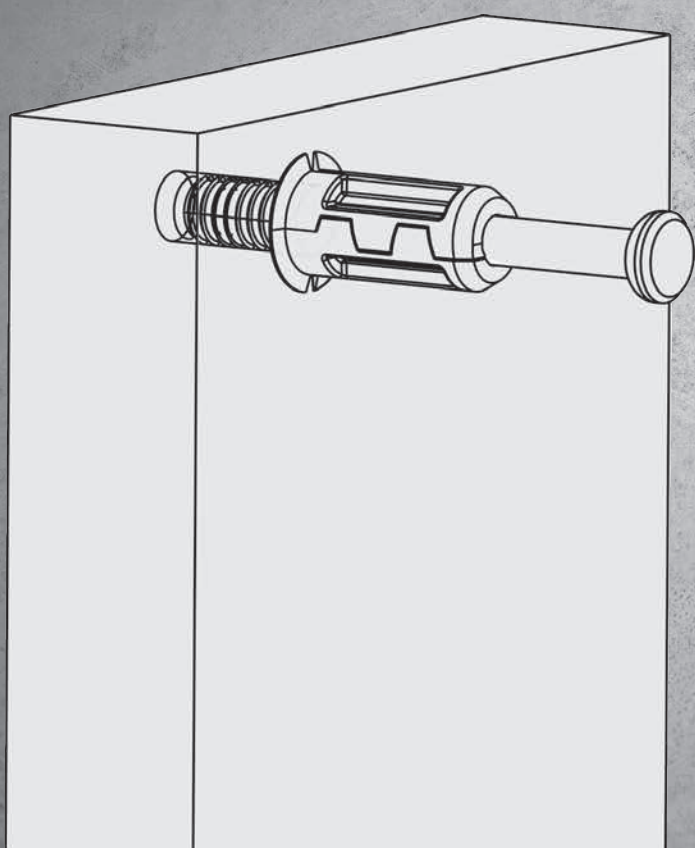

1 ECCENTRICO CLOCK E COVER

Cover Ø4 mm.

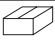
| | | | |
|-----------|----------|-------------|---|
| | | |  |
| Bianco | RAL 0003 | 531.217.002 | |
| Marrone | RAL 8016 | 531.217.013 | 2.000 o 10.000 |
| Nero | RAL 9005 | 531.217.024 | |
| Nichelato | | 531.217.061 | |

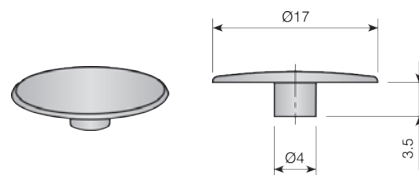



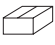

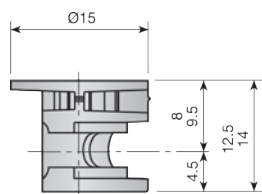
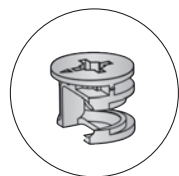
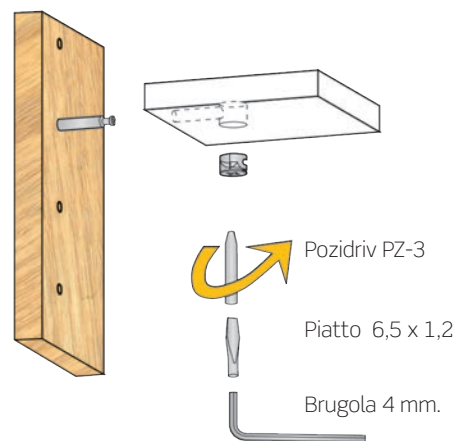

Eccentrico Clock Ø15 mm.

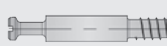
| | | | |
|-------------------|-------------|-------------|---|
| Spessore pannello | 16mm. | 19mm. | |
| C | 8mm. | 9,5mm. |  |
| Naturale | 511.108.102 | 511.195.101 | |
| Zincato nero | 511.108.043 | 511.195.042 | 2.000 |
| Nichelato | 511.108.065 | 511.195.064 | |

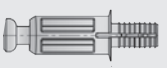

L'eccentrico Clock Ø15 mm. può essere utilizzato con tutti i nostri tiranti.

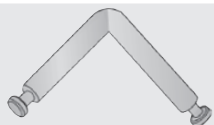
| | |
|---|--|
|  | Tirante in acciaio con filettatura per legno |
|  | Tirante in acciaio M6 |
|  | Tirante ad espansione |
|  | Tirante doppio con rondella di sicurezza |
|  | Tirante doppio |
|  | Tirante snodato |
|  | Tirante angolare a 90° |

2 TIRANTI

Tirante singolo

Filettatura diretta per legno.

| | | |
|-----------------|-------------|---|
| | D= 34mm. |  |
| Acciaio zincato | 523.834.032 | 500 |

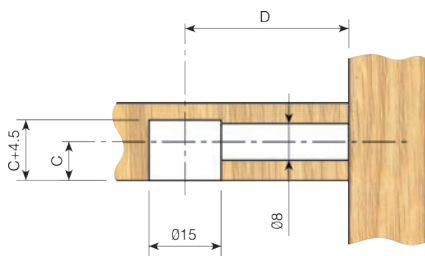
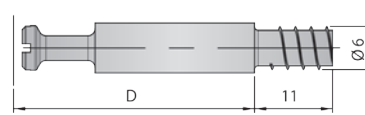

Tirante M6.

| | | |
|-----------------|-------------|---|
| | D= 34mm. |  |
| Acciaio zincato | 523.934.036 | 500 |

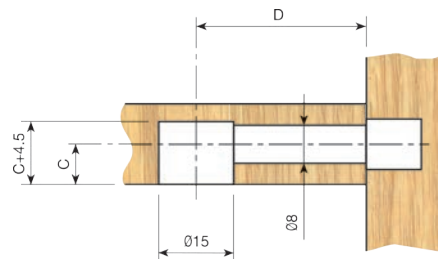
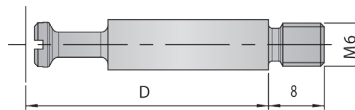

■ Tiranti doppi e snodati

Tiranti snodati.

| | | |
|---------|-------------|-------|
| Zincato | 524.144.036 | 1.000 |
|---------|-------------|-------|

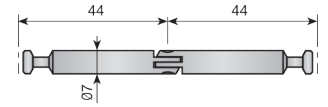
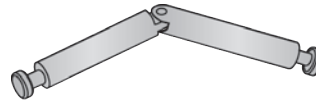
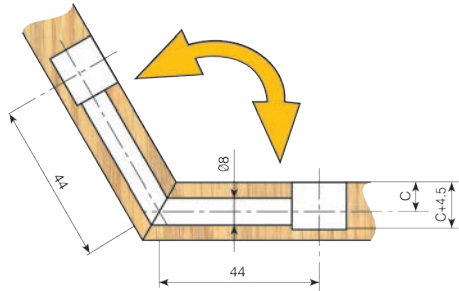

Tirante doppio angolare a 90°.

| | | |
|---------|-------------|-------|
| Zincato | 524.634.036 | 1.000 |
| | D= 34mm. | |

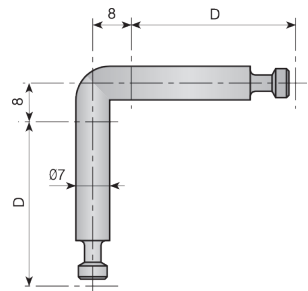
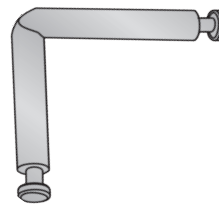
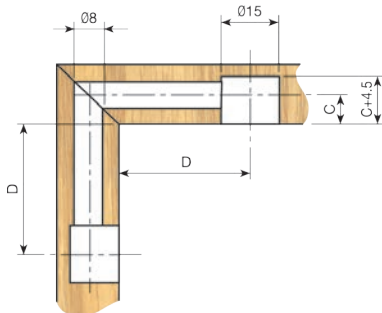

Tirante doppio.

| | | |
|---------|-------------|-------|
| Zincato | 524.834.030 | 1.000 |
| | D= 34mm. | |

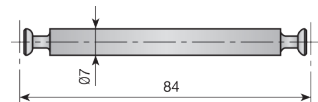
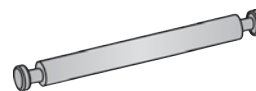
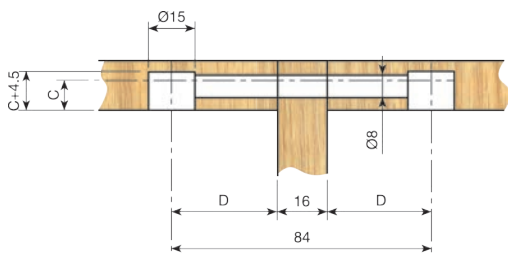

Tirante doppio con rondella di sicurezza.

| | | |
|---------|-------------|-------|
| Zincato | 524.724.034 | 1.000 |
| | D= 24mm | |

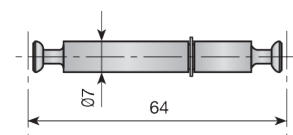
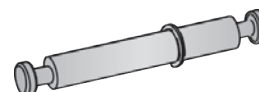
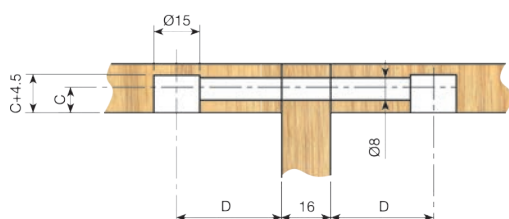

■ Tirante ad espansione

L'utilizzo di questo tirante implica un significativo miglioramento nella velocità di assemblaggio. Disponibile con interasse 24 o 34 mm e nelle versioni Ø5, Ø8 e Ø10 mm. .

Tirante ad espansione.

| Naturale | Ø5mm. | Ø8mm. | Ø10mm. |  |
|-----------|-------------|-------------|-------------|---|
| D= 24 mm. | 525.224.103 | 525.324.100 | 525.424.104 | 2.000 |
| D= 34 mm. | 525.234.102 | 525.334.106 | 525.434.103 | |

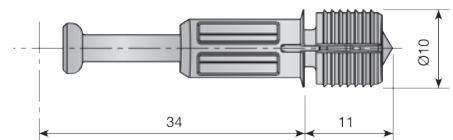
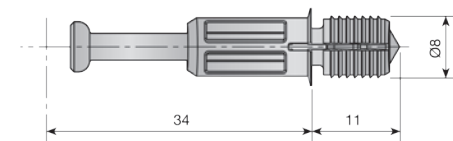
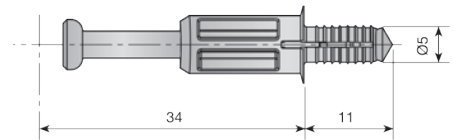
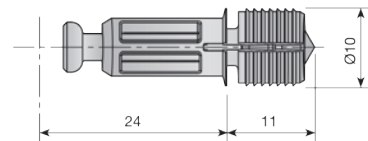
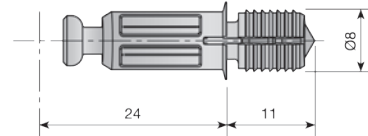
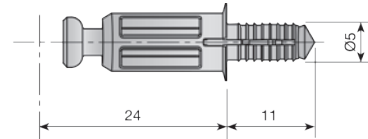

Può essere inserito e rimosso semplicemente con l'ausilio delle mani.

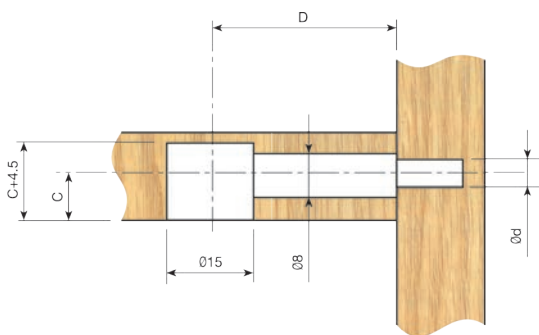

Montaggio

Girando l'eccentrico, il tirante si sposterà verso di esso unendo le due parti, ottenendo così un assemblaggio forte ed efficace.

